

Dosing technology Dosing system

preeflow[®] eco-CONTROL EC200-DUO by ViscoTec

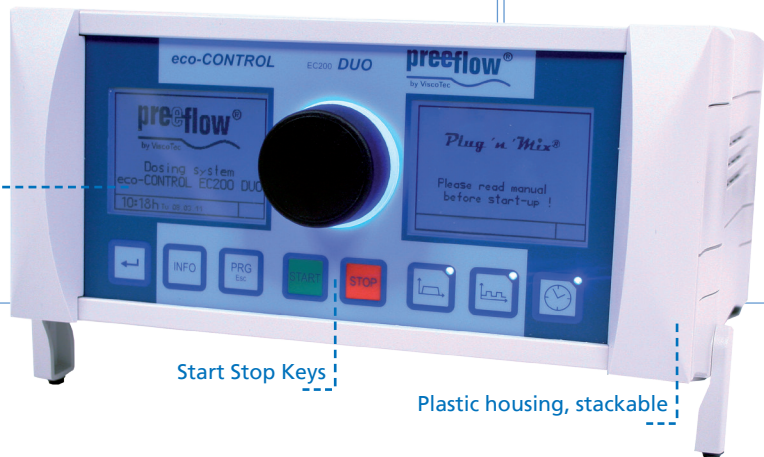

Two backlit displays

Start Stop Keys

Plastic housing, stackable

PRODUCT DESCRIPTION

The new and innovative eco-CONTROL EC200-DUO, made by ViscoTec offers a wide range of applications for the 2-K-precision-volume-dispenser eco-DUO450 and eco-DUO600.

THEORY OF FUNCTION

The control unit eco-CONTROL EC 200-DUO has been developed and tested for accurate work with the 2-K-precision-volume-dispenser eco-DUO. The control unit has a variety of configuration options to dosing, dispensing time and mixing ratio. All production-related values can be stored and changed at any time. The operation takes place over an intuitive user guidance using a graphical user interface. An integrated pressure control ensures the optimum process safety of the system. There is also the possibility of data exchange with a USB interface.

FUNCTIONS / PROGRAMS

- Quantity program
- Start / stop program
- Time program
- Mixing ratio up to 10:1
- Adjustable mixer sizes
- Adjustable individual pot life
- Flush out or empty shot
- Calibration manual / automatic
- Desired-volume display in grams or millilitres
- Dosage flow rate display in millilitres per minute or grams per minute
- Storage of PDM-supported dosing programs
- Desired-pressure and actual-pressure display in Bar or Psi
- Digital clock

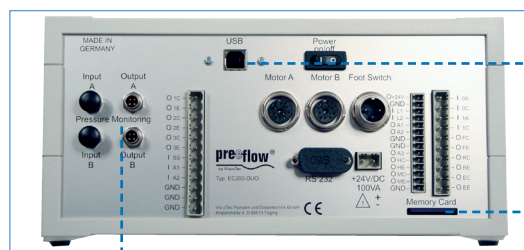

Connection for dispenser 1 & 2
Connection for foot switch
Terminal strip for interfaces
RS232, USB

SD-card, 24 dosing programs max;
readable with Microsoft operation
system

Connectors for
pressure monitoring

Illuminated navi wheel for easy
navigation through the menu

Plastic film keyboard
with LED status displays

Start / stop
program

Time program

Quantity program

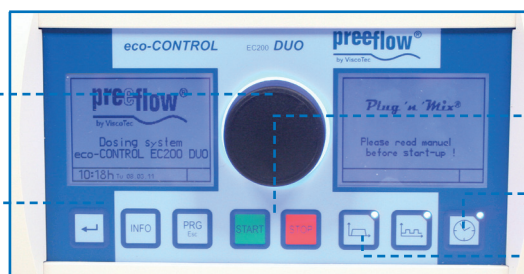

preeflow[®]
by ViscoTec

**eco-CONTROL
EC200-DUO**

Non-self levelling fluids, medium to high-viscosity media (with self-levelling liquids the inlet pressure eliminates)

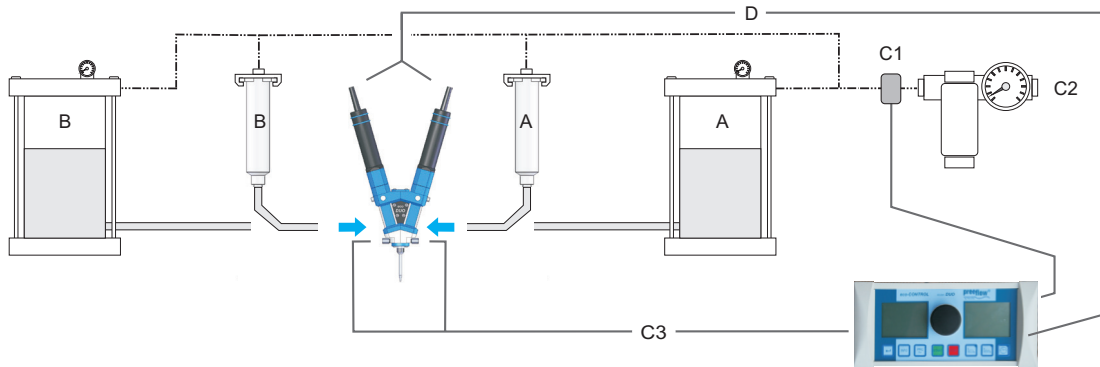

TECHNICAL DATA

Dimensions (HxWxD):	110 x 240 x 210 mm
Weight:	approx. 1300 grams
Voltage:	24 V DC / 3,75 A / RMS<200 mV, AC adapter included in delivery
AC adapter voltage:	230 V / 50 / 60 Hz
Power rating:	100 VA / 2,7 A
Start:	Key, foot switch, extern on terminal
External stop / start:	24 V impuls, 10 mA terminal strip; low 0 to 1,5 V; high 12 to 24 V
On-off switch:	yes
Interface:	USB, RS232
Inlet pressure monitoring:	0 to 7 bar optional
Outlet pressure monitoring:	0 to 40 bar
External memory:	MM C/SD-Card, 64 MB min; 24 dosing programs max;
Data evaluation:	optional readable outlet pressure signals
Operating conditions:	+10°C to +40°C, air pressure 1 bar
Medium temperature:	+10°C to +40°C
Storage environment:	dry / dust free; -10°C to +40°C
CE certified:	yes

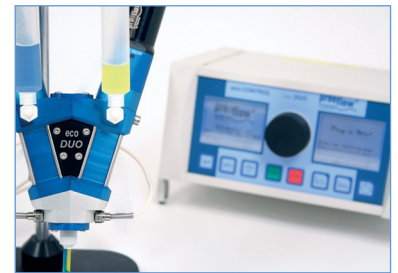

ViscoTec Pumpen- u. Dosiertechnik GmbH
Geschäftsfeld Komponenten & Geräte

Amperstraße 13 - D-84513 Töging a. Inn
Tel.: +49 (0) 8631 - 9274-00
Fax: +49 (0) 8631 - 9274-300
info@viscotec.de
www.viscotec.de



info@preeflow.com
www.preeflow.com

intertronics

adhesives, coatings, sealants & equipment
for your manufacturing and technology applications

† 01865 842842

e info@intertronics.co.uk

www.intertronics.co.uk